

PUMP INFORMATION

Model NO: _____
 Rating: _____ GPM _____ TDH
 Motor: _____ HP _____ RPM
 Elec: _____ PH _____ HZ _____ v
 Elec: _____ FL AMPS

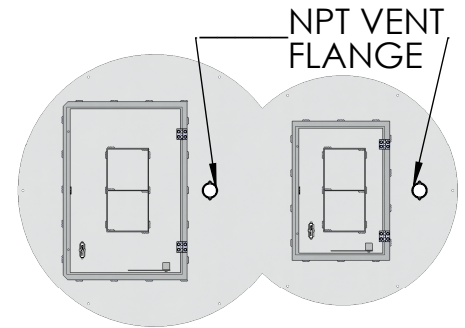

One Piece Hinged and Lockable Cover

Aluminum Steel

DISCHARGE PIPE

- 1-1/4"
- 1-1/2"
- 2"
- 3"

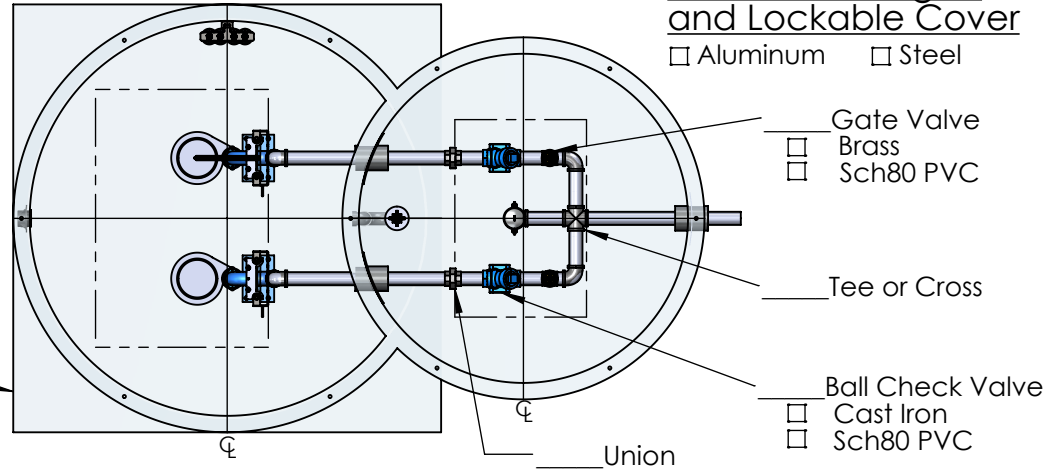

Anti-Floatation Flange
 Fiberglass Encapsulated
 ASTM A-36 Steel

3/16" Lifting Chain
 304 Stainless Steel
 *Stainless Steel Cable
 is Available

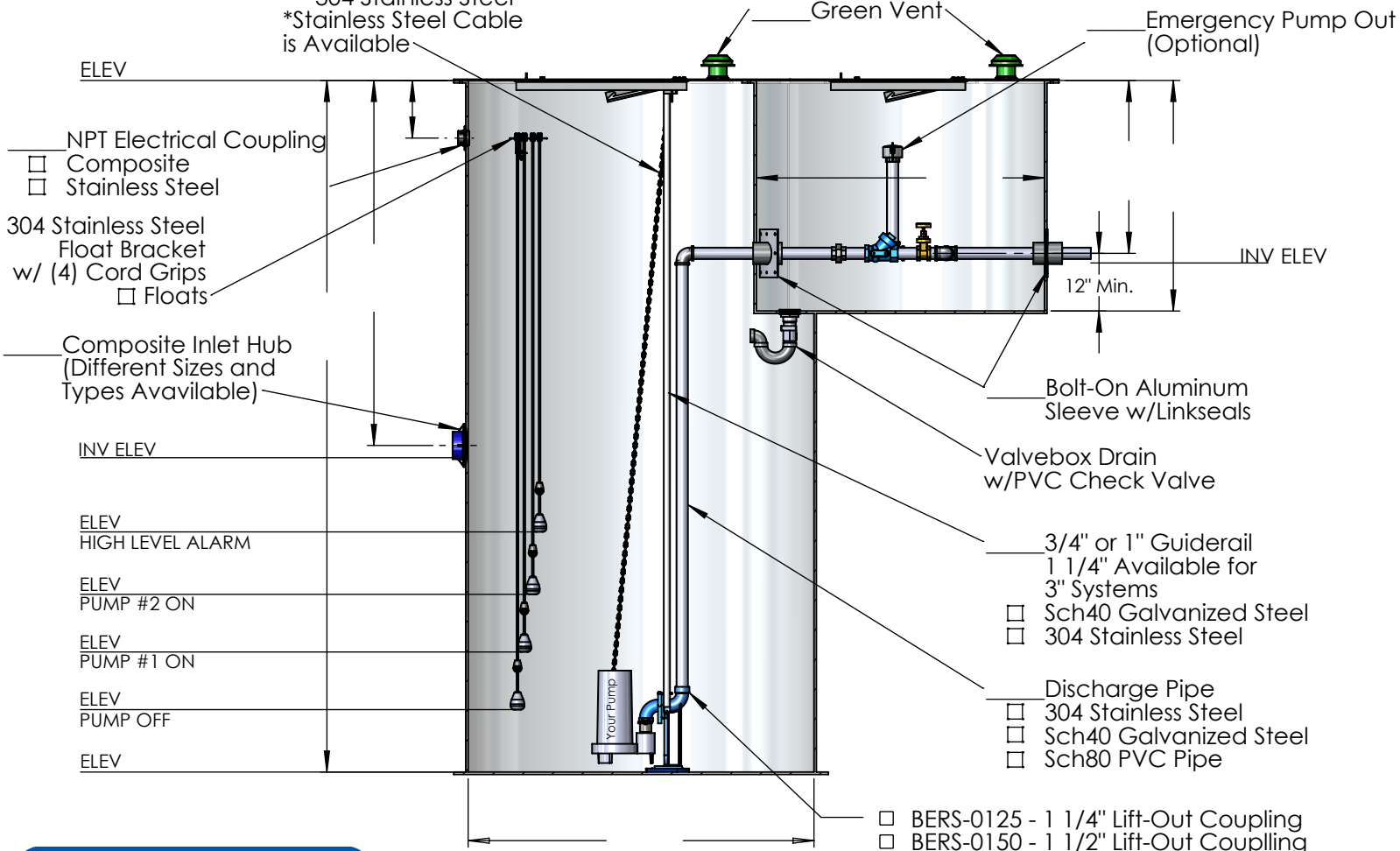

NPT Electrical Coupling
 Composite
 Stainless Steel

304 Stainless Steel
 Float Bracket
 w/ (4) Cord Grips
 Floats

Composite Inlet Hub
 (Different Sizes and
 Types Available)

INV ELEV

ELEV
 HIGH LEVEL ALARM

ELEV
 PUMP #2 ON

ELEV
 PUMP #1 ON

ELEV
 PUMP OFF

ELEV

Green Vent
 Emergency Pump Out
 (Optional)

INV ELEV

12" Min.

Bolt-On Aluminum
 Sleeve w/Linkseals

Valvebox Drain
 w/PVC Check Valve

3/4" or 1" Guiderail
 1 1/4" Available for
 3" Systems
 Sch40 Galvanized Steel
 304 Stainless Steel

Discharge Pipe
 304 Stainless Steel
 Sch40 Galvanized Steel
 Sch80 PVC Pipe

- BERS-0125 - 1 1/4" Lift-Out Coupling
- BERS-0150 - 1 1/2" Lift-Out Coupling
- BERS-0200 - 2" Lift-Out Coupling
- BERS-0320 - 3" Lift-Out Coupling for 2" Pump
- BERS-0300 - 3" Lift-Out Coupling

