

# FLEXIBLE ENTRY BOOT

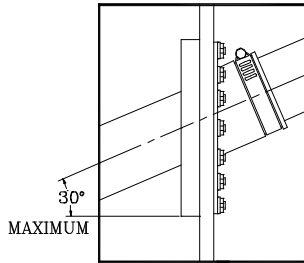

Boot Application For:  
Flat Wall Sumps

PART NO.	DESCRIPTION	HOLE SAW
FB050	1/2" BOOT FITTING	2 3/8"
FB075	3/4" BOOT FITTING	2 3/8"
FB100	1" BOOT FITTING	2 3/8"
FB150	1 1/2" BOOT FITTING	2 3/8"
FB200	2" BOOT FITTING	4 1/4"
FB300	3" BOOT FITTING	4 1/4"
FB350	3 1/2" BOOT FITTING	5 1/2"
FB400	4" BOOT FITTING	5 1/2"
FB600	6" BOOT FITTING	SABRE SAW

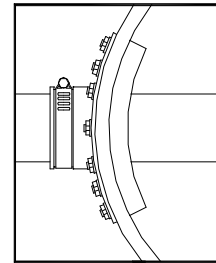

Boot Application For:  
Round Wall Sumps

## FIVE STEP INSTALLATION

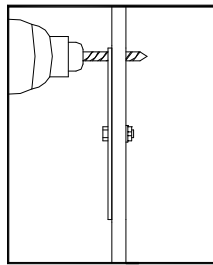

### Step #1

Locate the center entry point in the basin wall and drill the stud holes in the side wall using the guide template and a 5/16" drill bit.

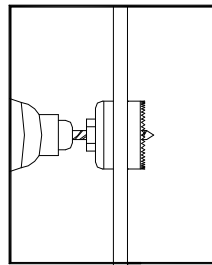

### Step #2

Remove the template and drill the opening hole for the Flexible Entry Boot using the appropriate size hole saw. (see table above)

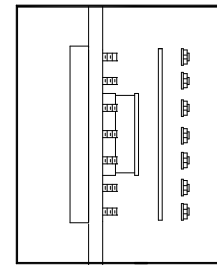

### Step #3

Insert the entry boot through the opening and then install the compression ring and fasteners.

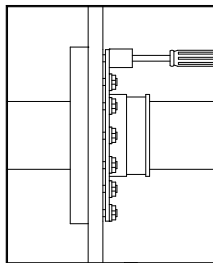

### Step #4

Tighten each of the fasteners firmly with a socket wrench fitted with a 7/16" socket. On round wall applications, tighten each nut in stages so the boot flange and compression ring can evenly conform to the rounded surface.

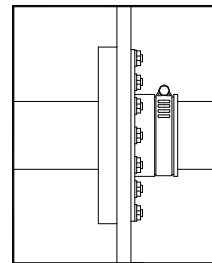

### Step #5

Insert pipe or conduit through the Flexible Entry Boot. Install and tighten band clamp to 30 in. lbs.

**INDUSTRIES**  
**TOPP**  
INCORPORATED

### FLEXIBLE ENTRY BOOT

Reference: -

Scale: None

Drawn By: RM

App'd By: .

Date: 07/08/03

This print is and contains confidential proprietary information owned exclusively by TOPP INDUSTRIES, INC. It is furnished on a strictly confidential basis. This restriction includes, but is not limited to the condition that this print will not only be used as a record or to identify or inspect parts or for other information purposes and will not be used to manufacture or procure the manufacture of the items shown in this print by any other source than TOPP INDUSTRIES, INC.

Highway 25 North P.O. Box 420  
Rochester, IN 46975  
Phone: 800/354-4534 Fax: 574/223-6106

Supersedes Prints  
Prior To: 07/08/03

Reference No: 10152

### Revisions

① First Released 06/27/03
